

Skyline

On top of Brussimmo building
Rue de Trèves 74 - 1040 Brussels



The building



Designed by the renowned Belgian architect Philippe Samyn, this iconic building is located in the heart of Brussel's European Quarter. Its double-skin glass façade blends sophistication with functionality, offering abundant natural light and acoustic comfort across 6,450 sqm.

The Skyline is ideally located on the top floor of this building called Brussimmo, right under its impressive dome.





Skyline

The venue

The Skyline is a one-of-a-kind 620 sqm, ready-to-use venue tailored for conferences, gatherings, and private dinners, consisting of 2 adjacent rooms as follows:

Main room:

230 square meters
Up to 150 attendees

Extra room:

120 square meters
Up to 100 attendees

Need breakout rooms?

The building also offers 8 versatile meeting rooms of various sizes, with a capacity of 50 for the largest room.



The possibilities

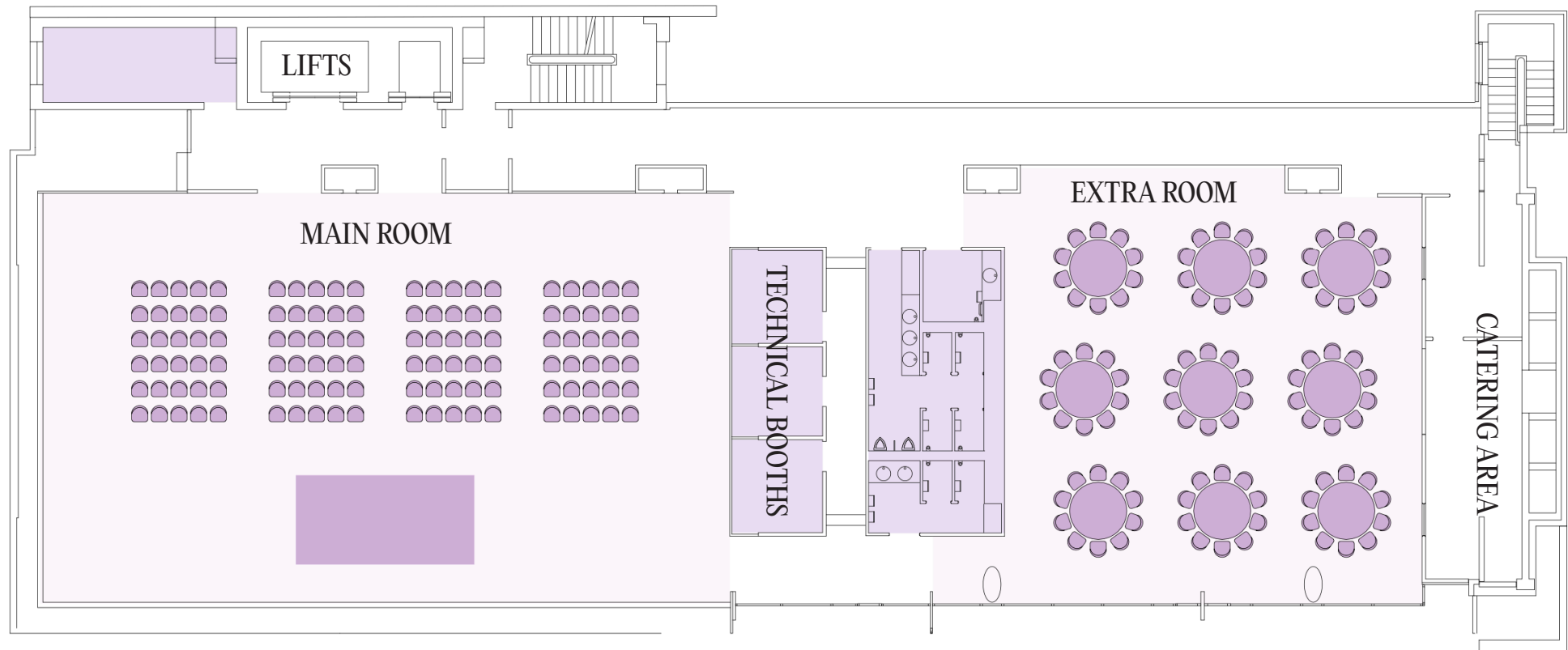

Main room:

- Included AV kit (sound, light, video, podium)
- Panoramic glass walls
- Impressive dome ceiling
- Chairs & other furniture available
- Use it for: conferences, cocktails, meetings,...

Extra room:

- More intimate
- Blank canvas
- Chairs, table & other furniture available
- Use it for: conferences, dinners, workshops,...



Contact



Charlotte Verhoogen

Event Manager

+32 (0) 486 43 43 32

charlotte.verhoogen@respace.be

Access

Rue de Trèves 74 - 1040 Brussels

Metro: Malbeek Station (5 min)

Train: Schuman Station (4 min)

Bus: 21, 27, 64, 543 Stib lines (1 min)

Car Parkings:

BePark - Maelbeek (2 min)

BePark - European Parliament (3 min)

BePark - Schuman (3 min)